

# ARC Tubular AC Motor

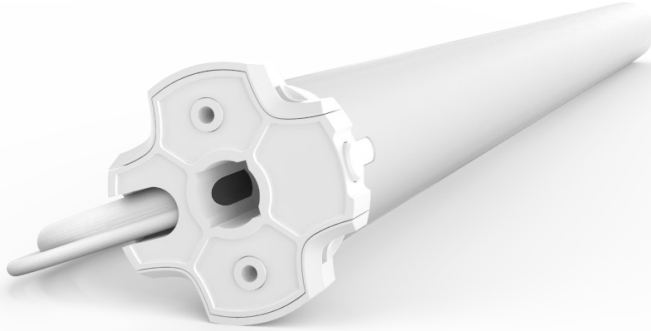

BI-DIRECTIONAL  
COMMUNICATION



SIMPLIFIED  
SETUP



FAVORITE  
POSITIONING



PRECISE LIMIT  
ADJUSTMENT



AUTOMATE | E tubular AC motors combine the simple, intuitive features of ARC “Automate Radio Communication” with the higher lifting capacity of an AC motor for larger shade applications.

Leveling Control allows for precise positioning of individual or multiple shades ensuring perfect alignment every time whilst bi-directional communication ensures you can always keep track of your shades position when integrated into smart home applications.

### FEATURES:

- Electronic Limits
- A/C Line Voltage (available for both 100V-120V & 220V-240V applications)
- 433 MHz Bi-Directional RF Communication
- Leveling Control
- Favorite Position
- Roller & Tilt Modes
- “Slim Head” design Reduces Light Gaps
- Quiet Operation



# CONTENTS

<b>1</b>	<b>ASSEMBLY</b>	<b>6</b>
<b>2</b>	<b>WIRING</b>	<b>7</b>
2.1	Power options	7
<b>3</b>	<b>P1 BUTTON FUNCTIONS</b>	<b>8</b>
3.1	Motor state test	8
<b>4</b>	<b>INITIAL SET-UP</b>	<b>9</b>
4.1	Pair motor with controller	9
4.2	Check motor direction	9
4.3	Set limits	10
<b>5</b>	<b>ADJUSTING LIMITS</b>	<b>11</b>
5.1	Adjust upper limit	11
5.2	Adjust lower limit	11
<b>6</b>	<b>ADDING OR REMOVING CONTROLLERS AND CHANNELS</b>	<b>12</b>
6.1	Using motor P1 button	12
6.2	Using a pre-existing controller	12
<b>7</b>	<b>FAVORITE POSITIONING</b>	<b>13</b>
7.1	Set a favorite position	13
7.2	Send shade to favorite position	13
7.3	Delete favorite position	13
<b>8</b>	<b>TILT &amp; ROLLER MODE</b>	<b>14</b>
8.1	Enter tilt mode	14
8.2	Enter roller mode (Default)	14
<b>9</b>	<b>SLEEP MODE</b>	<b>14</b>
<b>10</b>	<b>TROUBLESHOOTING</b>	<b>15</b>

# FCC & ISED STATEMENT

## FCC & ISED STATEMENT

This device complies with part 15 of the FCC Rules. Operation is subject to the following two conditions: (1) This device may not cause harmful interference, and (2) this device must accept any interference received, including interference that may cause undesired operation.

**Caution:** Changes or modifications to this unit not expressly approved by the party responsible for compliance could void the user's authority to operate the equipment.

This device contains licence-exempt transmitter(s)/receiver(s) that comply with Innovation, Science and Economic Development Canada's licence-exempt RSS(s). Operation is subject to the following two **conditions:**

- (1) This device may not cause interference.
- (2) This device must accept any interference, including interference that may cause undesired operation of the device.

L'émetteur/récepteur exempt de licence contenu dans le présent appareil est conforme aux CNR d'Innovation, Sciences et Développement économique Canada applicables aux appareils radio exempts de licence. L'exploitation est autorisée aux deux conditions suivantes :

- 1) L'appareil ne doit pas produire de brouillage.
- 2) L'appareil doit accepter tout brouillage radioélectrique subi, même si le brouillage est susceptible d'en compromettre le fonctionnement.

**NOTE:** This equipment has been tested and found to comply with the limits for a Class B digital device, pursuant to part 15 of the FCC Rules. These limits are designed to provide reasonable protection against harmful interference in a residential installation. This equipment generates, uses and can radiate radio frequency energy and, if not installed and used in accordance with the instructions, may cause harmful interference to radio communications. However, there is no guarantee that interference will not occur in a particular installation. If this equipment does cause harmful interference to radio or television reception, which can be determined by turning the equipment off and on, the user is encouraged to try to correct the interference by one or more of the following measures:

- Reorient or relocate the receiving antenna.
- Increase the separation between the equipment and receiver.
- Connect the equipment into an outlet on a circuit different from that to which the receiver is connected.
- Consult the dealer or an experienced radio/TV technician for help.



Do not dispose of in general waste.  
Please recycle batteries and damaged  
electrical products appropriately.



# SAFETY INSTRUCTIONS

## WARNING: Important safety instructions to be read before installation.

Incorrect installation can lead to serious injury and will void manufacturer's liability and warranty.

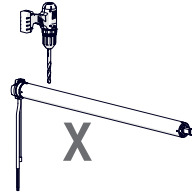
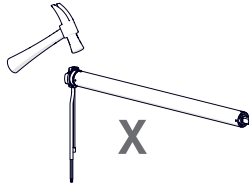

## CAUTION

- Do not expose to moisture or extreme temperatures.
- Do not allow children to play with this device.
- Use or modification outside the scope of this instruction manual will void warranty.
- Installation and programming to be performed by a suitably qualified installer.
- For use within tubular blinds.
- Ensure correct crown and drive adaptors are used for the intended system.
- Keep antenna straight and clear from metal objects
- Do not cut the antenna.
- Use only Rollease Acmeda hardware.
- Before installation, remove any unnecessary cords and disable any equipment not needed for powered operation.
- Ensure torque and operating time is compatible with end application.
- Do not expose the motor to water or install in humid or damp environments.
- Motor is to be installed in horizontal application only.
- Do not drill into motor body.
- The routing of cable through walls shall be protected by isolating bushes or grommets.
- Ensure power cable and aerial is clear and protected from moving parts.
- If cable or power connector is damaged do not use.

## Important safety instructions to be read prior to operation.

- It is important for the safety of persons to follow the enclosed instructions. Save these instructions for future reference.
- Persons (including children) with reduced physical, sensory or mental capabilities, or lack of experience and knowledge should not be allowed to use this product.
- Keep remote controls away from children.
- Frequently inspect for improper operation. Do not use if repair or adjustment is necessary.
- Keep motor away from acid and alkali.
- Do not force the motor drive.
- Keep clear when in operation.

# 1 ASSEMBLY

Please refer to Rollease Acmeda System Assembly Manual for full assembly instructions relevant to the hardware system being used.

**Step 1.** Cut roller tube to required length.

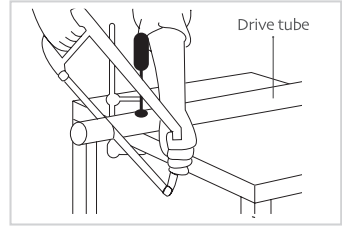

**Step 2.** Ensure roller tube is clean and free from burrs.

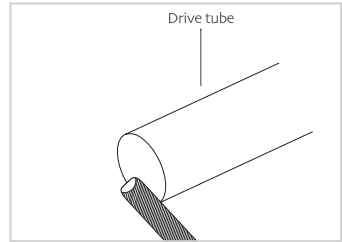

**Step 3.** Fit required crown, drive and bracket adapters.

Tube must be close fitting with chosen crown and drive adapters. Refer to Rollease Acmeda System Assembly Manual for recommended crown, drive, and bracket adapter kits.

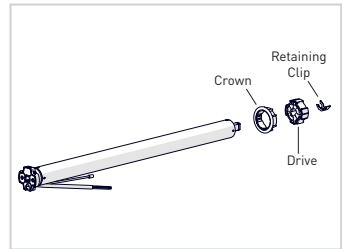

**Step 4.** Slide Motor into tube.

Insert by aligning keyway in crown and drive wheel to the tube.

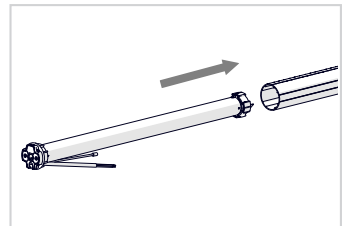

**Step 5.** Mount motorized tube onto brackets.

Refer to Rollease Acmeda System Assembly Manual for recommended crown, drive, and bracket adapter kits.

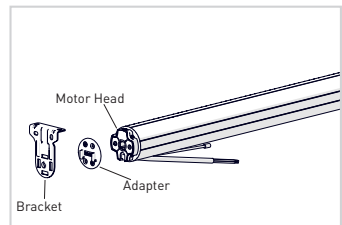

## 2 WIRING

### 2.1 Power options

Cut off the mains power supply

Connect the motor according to the information in the table below.

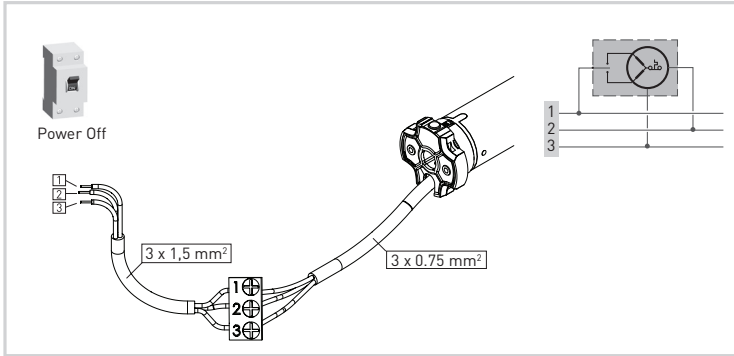

Range	Neutral	Live	Earth
220-240V	Blue	Brown	Yellow / Green
100-120V	White	Black	Green



Ensure cable is kept clear of fabric.

Ensure antenna is kept straight and away from metal objects.

# 3 P1 BUTTON FUNCTIONS

## 3.1 Motor state test

This table describes the function of a short **P1** button press/release (<2 seconds) depending on current motor configuration.

P1 Press	Condition	Function Achieved	Visual Feedback	Audible Feedback	Function Described
Short Press	If limit is NOT set	None	No Action	None	No Action
	If limits are set	Operational control of motor, run to limit. Stop if running	Motor runs	None	Operational control of motor after pairing and limit setting is completed first time
	If motor is in "Sleep Mode" & limits are set	Wake and control	Motor wakes and runs in a direction	None	Motor is restored from Sleep Mode and RF control is active

## 3.2 Motor configuration options

The **P1** Button is utilized to administer motor configuration as described below and beginning in Section

### Activate Pairing Mode



Hold P1

P1

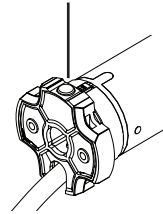

### Sleep Mode



### Reverse Direction

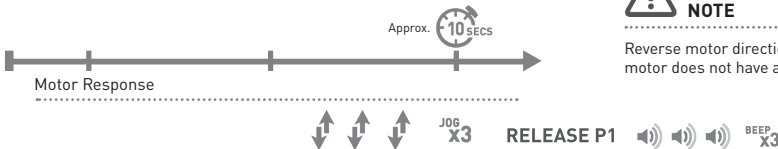

### NOTE

Reverse motor direction from **P1** button only when motor does not have any limits.

### Reset To Factory Settings

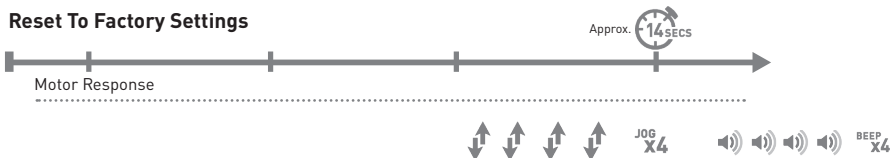



## 4 INITIAL SET-UP

### 4.1 Pair motor with controller

Select channel on controller.



Hold **P1** button on motor head.

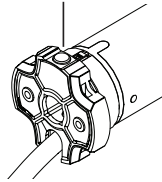

Hold **STOP** on controller.



#### IMPORTANT

Consult user manual for your controller for information on selecting channel.

Motor Response



Motor Response



#### Motor is now in step mode and ready for setting limits

### 4.2 Check motor direction

To check travel direction of shade, press **UP** or **DOWN** on controller.

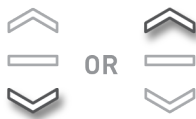

To reverse shade direction, hold both **UP** and **DOWN**.

Until the motor responds.



**Quick Press** = Step

**Long Press** = Continuous Travel

Motor Response



#### IMPORTANT

Damage to shade may occur when operating motor prior to setting limits. Attention should be given.

#### IMPORTANT

Reversing motor direction using this method is only possible during initial set-up.

## 4.3 Set limits

To save upper limit, hold **UP** and **STOP**.

Move shade to the desired highest or lowest position by pressing the **UP** or **DOWN** buttons on controller.



To save lower limit, hold **DOWN** and **STOP**.



### IMPORTANT

Cycle shade up and down prior to setting limits to settle fabric

### Motor Response

Approx.  5 SECS



### IMPORTANT

After setting limits, motor will automatically exit from initial set-up mode.



**Initial set-up is now complete**

# 5 ADJUSTING LIMITS

## 5.1 Adjust upper limit

Hold **UP** and **STOP** on controller.



Move shade to the desired highest position by pressing the **UP** button.



To save upper limit, hold **UP** and **STOP**.



Motor Response



Motor Response



## 5.2 Adjust lower limit

Hold **DOWN** and **STOP** on controller.



Move shade to the desired lowest position by pressing the **DOWN** button.



To save lower limit, hold **DOWN** and **STOP**.



Motor Response



Motor Response



# 6 ADDING OR REMOVING CONTROLLERS AND CHANNELS

## 6.1 Using motor P1 button

Hold **P1** button on motor head.

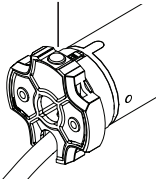

Hold **STOP** on controller to add or remove.



Motor Response



Motor Response



## 6.2 Using a pre-existing controller

**A**= Existing controller or channel (to keep)

**B**= Controller or channel to add or remove

Press **P2** on existing controller.



Press **P2** on existing controller.

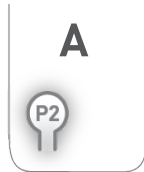

Press **P2** on new controller.

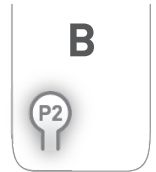

Motor Response



Motor Response



Motor Response



**IMPORTANT**

Consult user manual for your controller or sensor.

## 7 FAVORITE POSITIONING

### 7.1 Set a favorite position

Move shade to the desired position by pressing the **UP** or **DOWN** button on the controller.



Press **P2** on controller.



Motor Response



Press **STOP** on controller.



Motor Response



Press **STOP** on controller.



Motor Response



### 7.2 Send shade to favorite position

Hold **STOP** on controller.



### 7.3 Delete favorite position

Press **P2** on controller.



Motor Response



Press **STOP** on controller.



Motor Response



Press **STOP** on controller.



Motor Response



## 8 TILT & ROLLER MODE

### 8.1 Enter tilt mode

For slat adjustment on venetians.

Hold **UP** and **DOWN** on controller.

Press **STOP**.



Motor Response



Motor Response



### 8.2 Enter roller mode (Default)

Hold **UP** and **DOWN** on controller.

Press **STOP**.



Motor Response



Motor Response



## 9 SLEEP MODE

### Enter Sleep Mode

Sleep mode is utilized to prevent a motor from moving during shipping of a fabricated shade

Hold **P1** button on the motor head

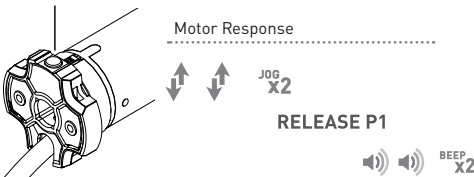

### Exit Sleep Mode

Exit sleep mode once the shade is installed

Press and release **P1** button on the motor head

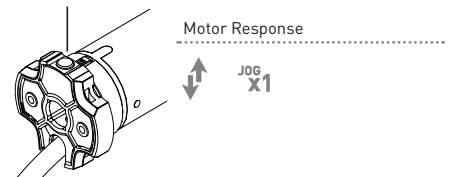

Problem	Cause	Remedy
Motor is not responding	A/C power supply not plugged in.	Check motor to power cable connection and AC plug.
	Transmitter battery is discharged	Replace battery
	Radio interference/shielding	Ensure transmitter is positioned away from metal objects and the aerial on motor or receiver is kept straight and away from metal
	Receiver distance is too far from transmitter	Move transmitter to a closer position
	Power failure	Check power supply to motor is connected and active
	Incorrect wiring	Check that wiring is connected correctly (refer to motor installation instructions)
Cannot program a single Motor (multiple motors respond)	Multiple motors are paired to the same channel.	Always reserve an individual channel for programming functions
		SYSTEM BEST PRACTICE - Provide an extra 15 channel controller in your multi motor projects, that provides individual control for each motor for programming purposes
		Place all other motors into sleep mode (ref to <b>P1</b> button function overview - Section 3)

**ROLLEASE ACMEDA | USA**

Level 7 / 750 East Main Street  
Stamford, CT 06902, USA

T +1 800 552 5100 | F +1 203 964 0513

**ROLLEASE ACMEDA | AUSTRALIA**

110 Northcorp Boulevard,  
Broadmeadows VIC 3047, AUS

T +61 3 9355 0100 | F +61 3 9355 0110

**ROLLEASE ACMEDA | EUROPE**

Via Conca Del Naviglio 18,  
Milan (Lombardia) Italy

T +39 02 8982 7317 | F +39 02 8982 7317